

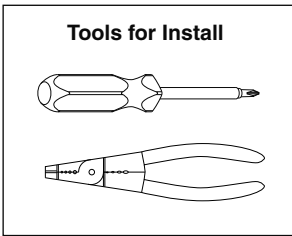

941071-00

# VON DUPRIN®

Installation Instructions  
EPT2 & EPT10 Electric Power Transfer



**Read all Warnings Before Starting Installation!**

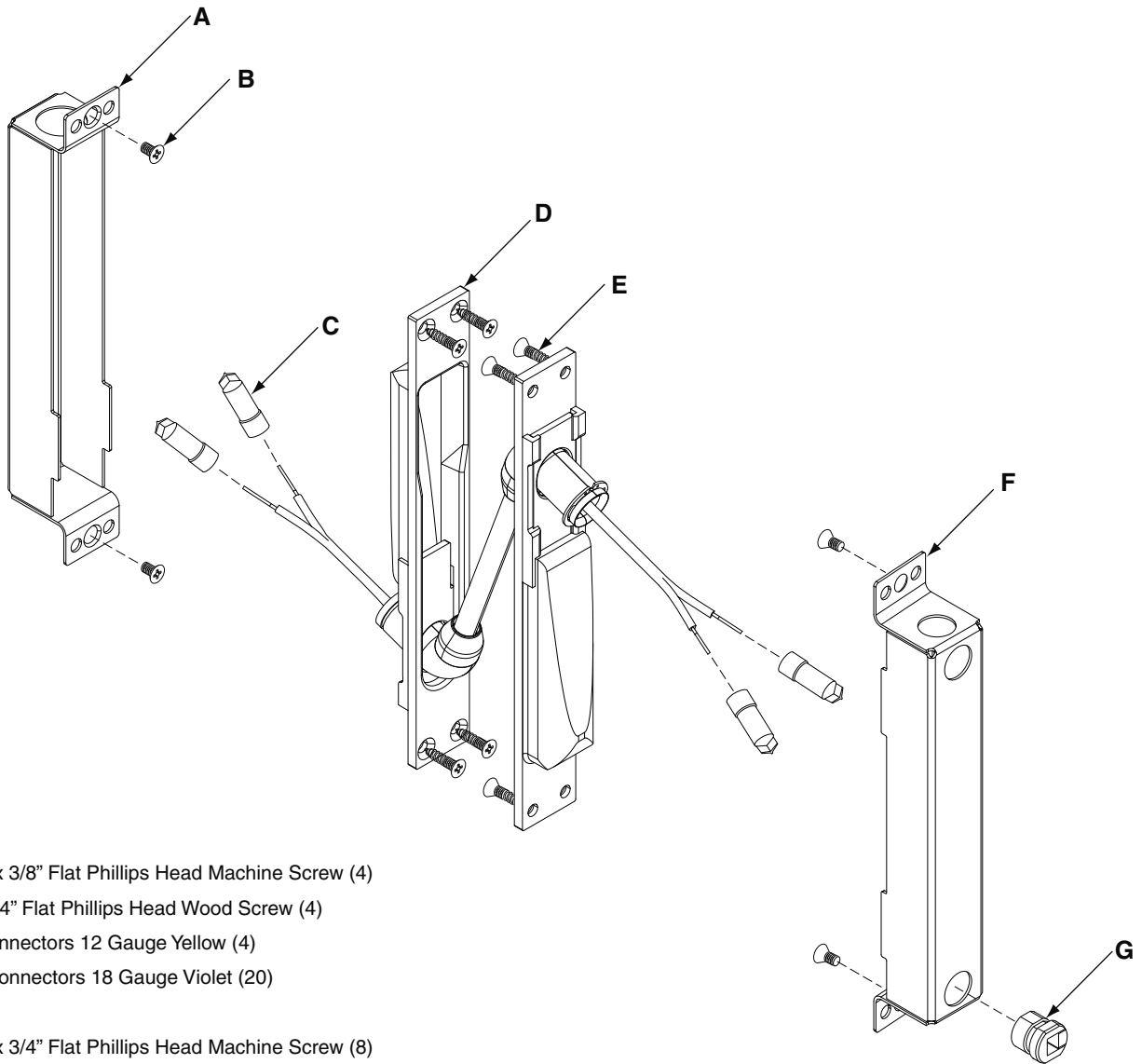

- A. Frame Backbox
- B. Metal - #10-24 x 3/8" Flat Phillips Head Machine Screw (4)  
Wood - #10 x 3/4" Flat Phillips Head Wood Screw (4)
- C. EPT2 - Wire Connectors 12 Gauge Yellow (4)  
EPT10 - Wire Connectors 18 Gauge Violet (20)
- D. EPT Assembly
- E. Metal - #10-24 x 3/4" Flat Phillips Head Machine Screw (8)  
Wood - #10 x 3/4" Flat Phillips Head Wood Screw (8)
- F. Door Backbox
- G. Strain Relief

## General Information

An EPT provides a wiring path from the door to the frame.

These instructions assume that a factory-prepped door and frame are being used. If the door and frame have not been factory-prepped, see the included template.

Before beginning the installation, review “Specifications” and “Warnings”.

## Specifications

### Applications

EPT **can** be used for:

- Door Thickness - 1-3/4” minimum
- Note: The following specifications apply to a 1-3/4” thick door.**
- 0 - 180° opening with up to 5” butt hinges
  - 0 - 180° opening with up to 3/4” offset pivots
  - 0 - 130° opening with 5-1/2” butt hinges
  - 0 - 110° opening with 6” butt hinges

EPT **cannot** be used for:

- 1-1/2” offset pivots
- larger than 6” butt hinges
- pocket pivots
- swing clear hinges
- center hung door (center pivot)
- balanced door

### Electrical Ratings

EPT2

- Two 18AWG wires
- Max. Rating: 24VDC, 5A or 120VAC NEC Class 3

EPT10

- Ten 24AWG wires
- Max Rating: 24VDC, 1A

## Read all Warnings Before Starting Installation!



Do not exceed rated specifications.



EPT must be installed in accordance with these instructions by a qualified electrician.



Wiring must be in accordance with all local codes and regulations.

# Installation

## 1 Use Template from Back Page to Check Preparation

## 2 Mount Frame Backbox

- A. Remove knockout from top
- B. Install 1/2" conduit, if used
- C. Pull 5" of field wiring through knockout

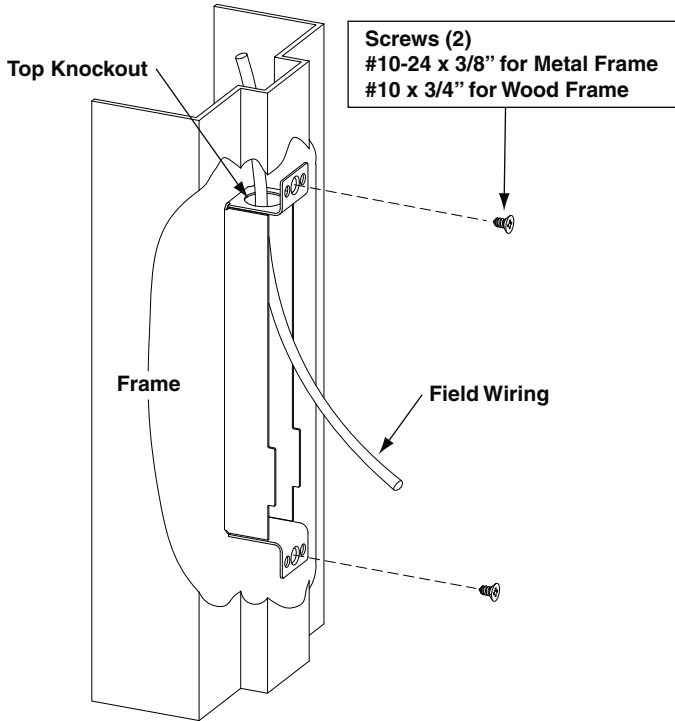

## 3 Mount Door Backbox

- A. Ensure backbox bevel matches door bevel
- B. Remove knockout: - from bottom for metal  
- from back for wood
- C. Pull 5" of field wiring through knockout
- D. Install strain relief

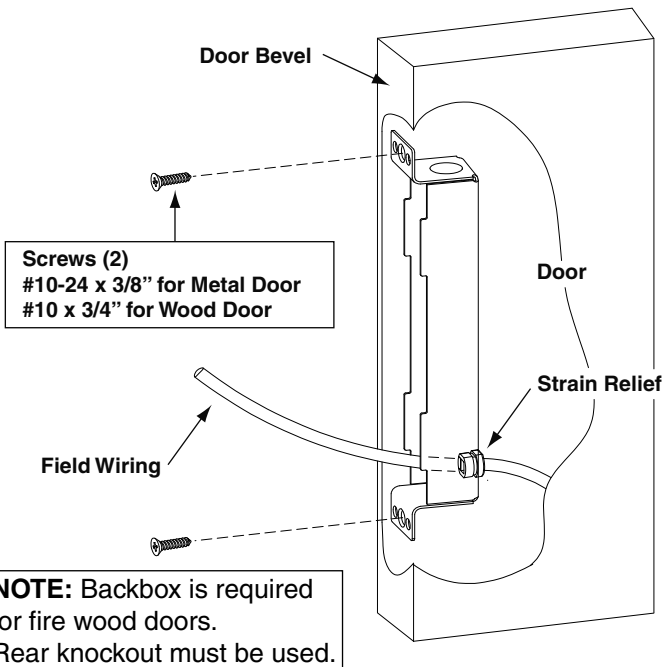

## 4 Connect Wires

- A. Use yellow connectors for 12AWG wires
- B. Use violet connectors for 18AWG wires

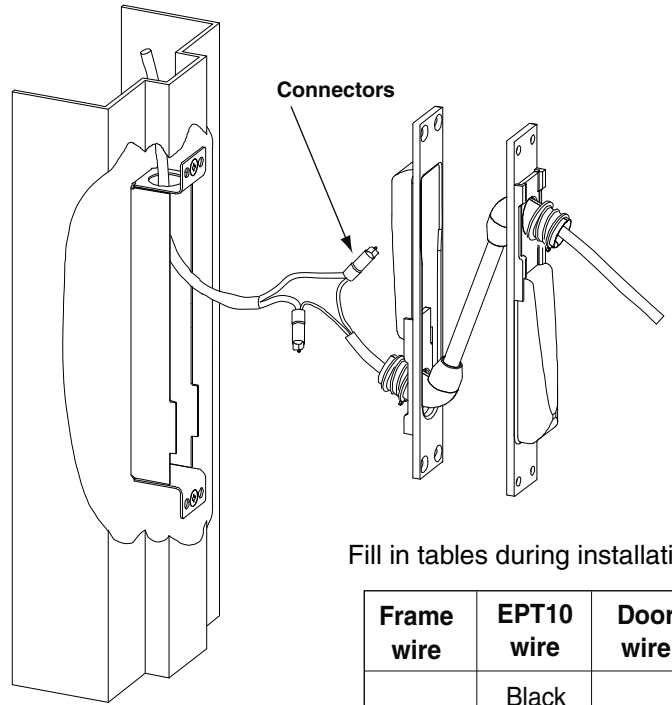

Fill in tables during installation

Frame wire	EPT2 wire	Door wire
	Black	
	Black-rib	

Frame wire	EPT10 wire	Door wire
	Black	
	Brown	
	Red	
	Orange	
	Yellow	
	Green	
	Blue	
	Violet	
	Gray	
	White	

## 5 Mount EPT Assembly

**Note:** Be careful not to pinch wires between backbox and EPT

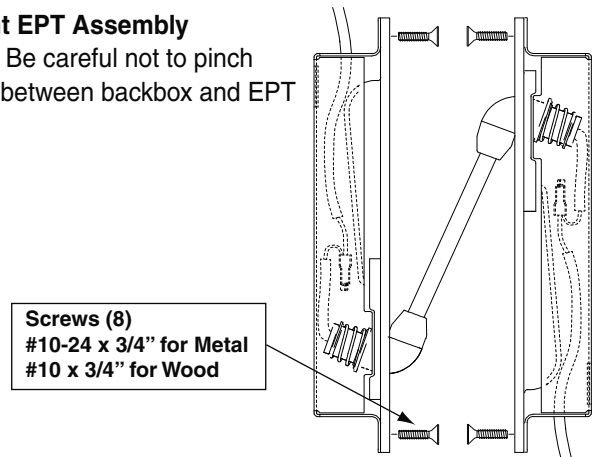

## 6 Verify that door opens and closes properly and that electrical components function

# Template

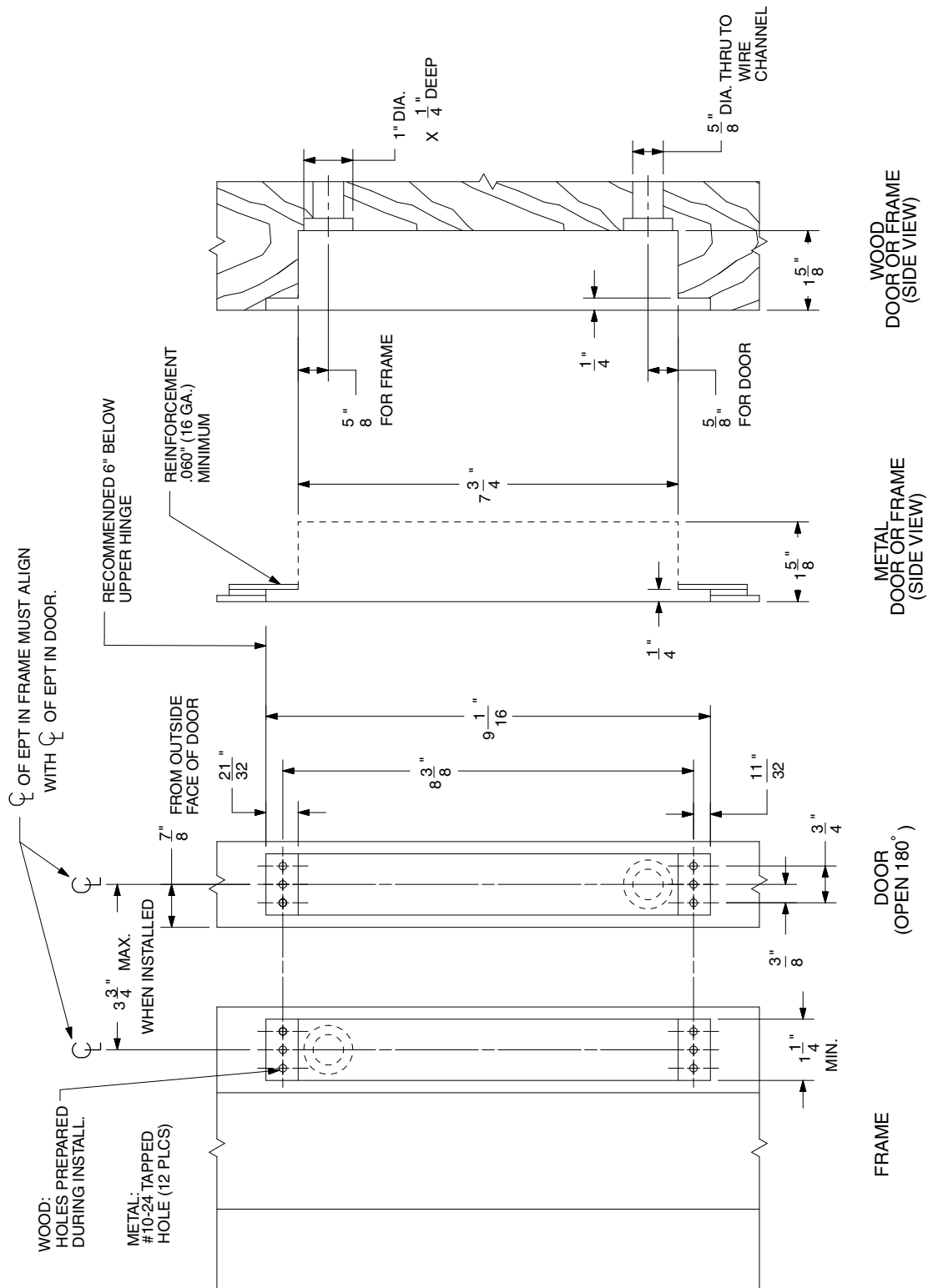

\*ALL DIMENSIONS ARE TYPICAL